

Pipe Size Adapters

Tube OD Weld x Schedule 5S Weld - B19WV

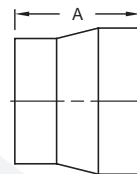

Pipe Size	Dimension A	Tube Wall Thickness	Pipe Wall Thickness	316L Stainless Steel Part #
1"	2.000"	.065"	.065"	B19WV-R100
1½"	2.500"	.065"	.065"	B19WV-R150
2"	2.500"	.065"	.065"	B19WV-R200
2½"	2.500"	.065"	.084"	B19WV-R250
3"	2.500"	.065"	.084"	B19WV-R300
4"	3.000"	.084"	.084"	B19WV-R400



Sanitary Fittings

Tube OD Weld x Schedule 10S Weld - B19WX



Pipe Size	Dimension A	Tube Wall Thickness	Pipe Wall Thickness	316L Stainless Steel Part #
1"	2.000"	.065"	.109"	B19WX-R100
1½"	2.500"	.065"	.109"	B19WX-R150
2"	2.500"	.065"	.109"	B19WX-R200
2½"	2.500"	.065"	.120"	B19WX-R250
3"	2.500"	.065"	.120"	B19WX-R300
4"	3.000"	.084"	.120"	B19WX-R400

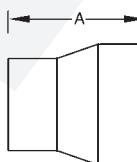

Clamp x Schedule 10S Weld - B19MPX



Pipe Size	Dimensions			Pipe Wall Thickness	316L Stainless Steel Part #
	A	B	C		
1"	1.125"	1.097"	1.315"	.109"	B19MPX-R100
1½"	1.125"	1.682"	1.900"	.109"	B19MPX-R150
2"	1.125"	2.157"	2.375"	.109"	B19MPX-R200
2½"	1.125"	2.635"	2.875"	.120"	B19MPX-R250
3"	1.125"	3.260"	3.500"	.120"	B19MPX-R300
4"	1.125"	4.260"	4.500"	.120"	B19MPX-R400

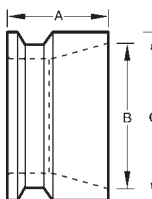

- For additional information on pipe dimensions please reference dixonvalve.com.