

Clamp Fittings - Ferrules

Sanitary Fittings

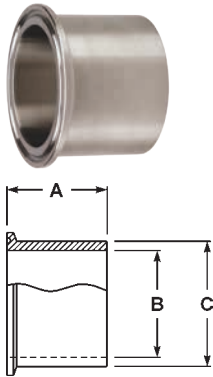

Tank (heavy duty) - 14MPW

Specification:

- certified ASME materials

| Tube OD | Dimensions |        |        | 316L Stainless Steel Part # |
|---------|------------|--------|--------|-----------------------------|
|         | A          | B      | C      |                             |
| ½"      | 1.625"     | .321"  | .502"  | <b>14MPW-R50</b>            |
| ¾"      | 1.625"     | .574"  | .750"  | <b>14MPW-R75</b>            |
| 1"      | 1.625"     | .870"  | 1.160" | <b>14MPW-R100</b>           |
| 1½"     | 1.625"     | 1.370" | 1.676" | <b>14MPW-R150</b>           |
| 2"      | 1.750"     | 1.870" | 2.192" | <b>14MPW-R200</b>           |
| 2½"     | 1.750"     | 2.370" | 2.708" | <b>14MPW-R250</b>           |
| 3"      | 1.813"     | 2.870" | 3.224" | <b>14MPW-R300</b>           |
| 4"      | 2.125"     | 3.834" | 4.256" | <b>14MPW-R400</b>           |
| 6"      | 2.500"     | 5.758" | 6.192" | <b>14MPW-R600</b>           |

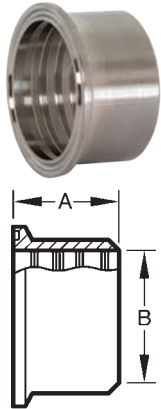

Roll-on for Expanding - 14RMP

| Tube OD | Dimensions |        | 304 Stainless Steel Part # | 316L Stainless Steel Part # |
|---------|------------|--------|----------------------------|-----------------------------|
|         | A          | B      |                            |                             |
| 1"      | .750"      | 1.005" | <b>14RMP-G100</b>          | <b>14RMP-R100</b>           |
| 1½"     | 1.125"     | 1.505" | <b>14RMP-G150</b>          | <b>14RMP-R150</b>           |
| 2"      | 1.312"     | 2.005" | <b>14RMP-G200</b>          | <b>14RMP-R200</b>           |
| 2½"     | 1.375"     | 2.505" | <b>14RMP-G250</b>          | <b>14RMP-R250</b>           |
| 3"      | 1.437"     | 3.005" | <b>14RMP-G300</b>          | <b>14RMP-R300</b>           |
| 4"      | 1.500"     | 4.005" | <b>14RMP-G400</b>          | <b>14RMP-R400</b>           |

<sup>1</sup> Meets 3-A Standard Number 63-03 when used to modify or repair existing on-site farm milk handling systems.

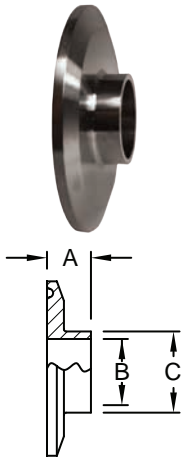

Reducing - B31WMP

| Tube OD   | Dimensions |        |        | 304 Stainless Steel Part # | 316L Stainless Steel Part # |
|-----------|------------|--------|--------|----------------------------|-----------------------------|
|           | A          | B      | C      |                            |                             |
| 2" x 1"   | .500"      | .870"  | 1.000" | <b>B31WMP-G200100</b>      | <b>B31WMP-R200100</b>       |
| 2½" x 1½" | .500"      | 1.370" | 1.500" | <b>B31WMP-G250150</b>      | <b>B31WMP-R250150</b>       |
| 2½" x 2"  | .500"      | 1.870" | 2.000" | <b>B31WMP-G250200</b>      | <b>B31WMP-R250200</b>       |
| 3" x 2"   | .500"      | 1.870" | 2.000" | <b>B31WMP-G300200</b>      | <b>B31WMP-R300200</b>       |
| 4" x 3"   | .625"      | 2.870" | 3.000" | <b>B31WMP-G400300</b>      | <b>B31WMP-R400300</b>       |